

Dimensions may vary depending on structural design and size of insulation material. All measurements in mm

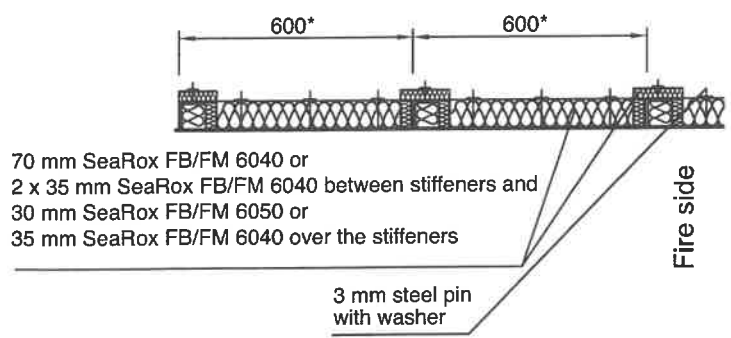

70 mm SeaRox FB/FM 6040 or
 2 x 35 mm SeaRox FB/FM 6040 between stiffeners and
 30 mm SeaRox FB/FM 6050 or
 35 mm SeaRox FB/FM 6040 over the stiffeners

3 mm steel pin
 with washer

Fire side



Subject: A-60 Steel Bulkhead
 Plate: SeaRox FB/FM 6040
 Stiffener: SeaRox FB/FM 6050 or SeaRox FB/FM 6040



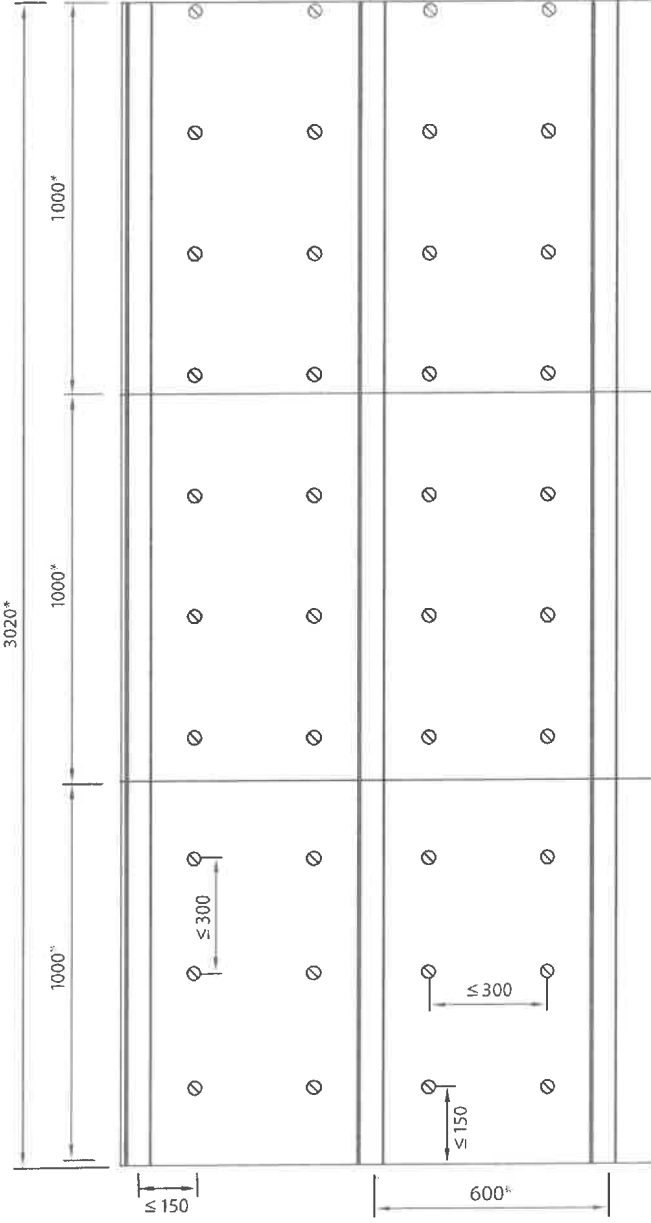

Bulkhead

All measurements in mm

* Dimensions may vary depending on structural design and size of insulation material.



Subject: A-60 Steel Bulkhead
 Plate: SeaRox FB/FM 6040
 Stiffener: SeaRox FB/FM 6050 or SeaRox FB/FM 6040

Date: 2021/10/25

Designer: DG

Drawing No. 700-2 / Rev 2



70 mm SeaRox FB/FM 6040 or
 2 x 35 mm SeaRox FB/FM 6040 between stiffeners and
 30 mm SeaRox FB/FM 6050 or
 35 mm SeaRox FB/FM 6040 over the stiffeners

3 mm steel pin
 with washer

Fire side

TECHNICAL INSULATION

TOP VIEW

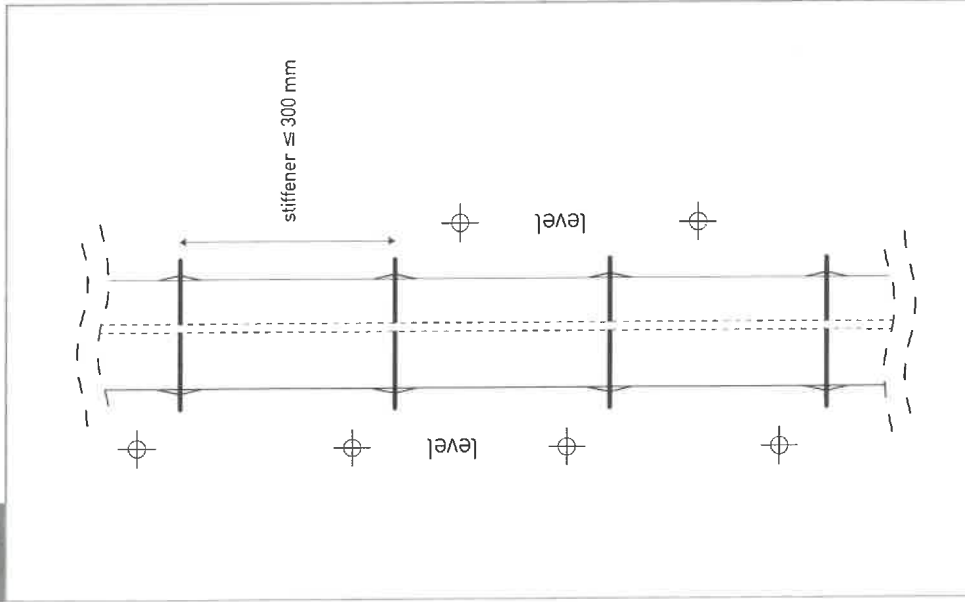

SECTION A

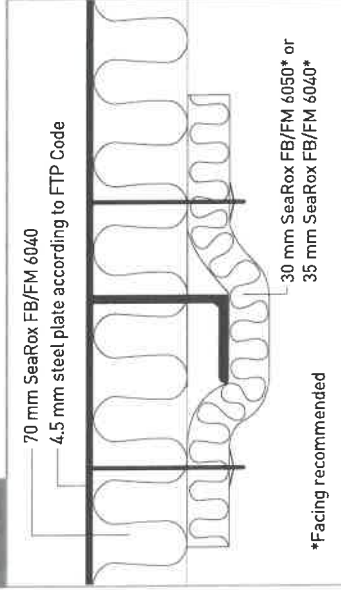

only with pin settings Drawing No. 700-2

SECTION B

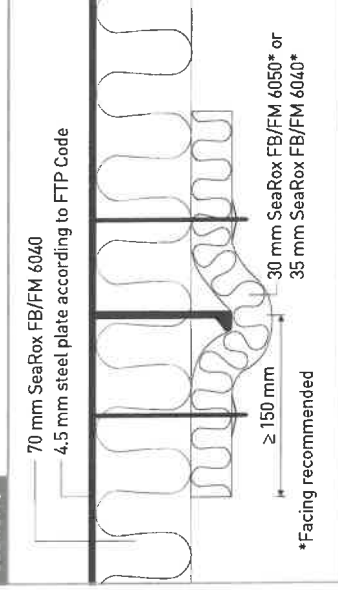

only with pin settings Drawing No. 700-2

SECTION C

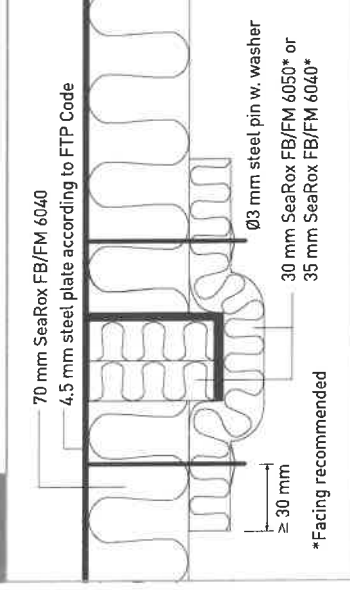

only with pin settings Drawing No. 700-2

SECTION D

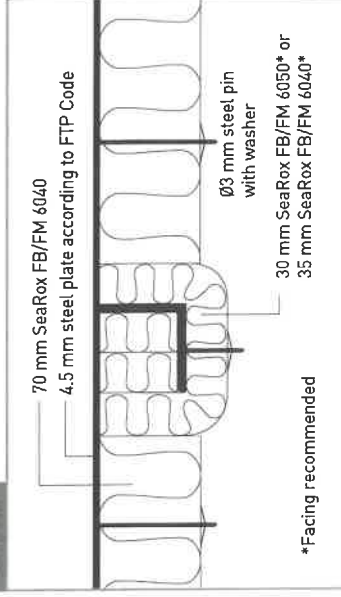

SECTION E

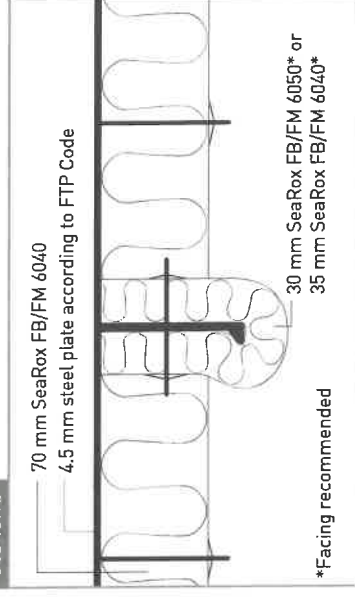

SECTION F

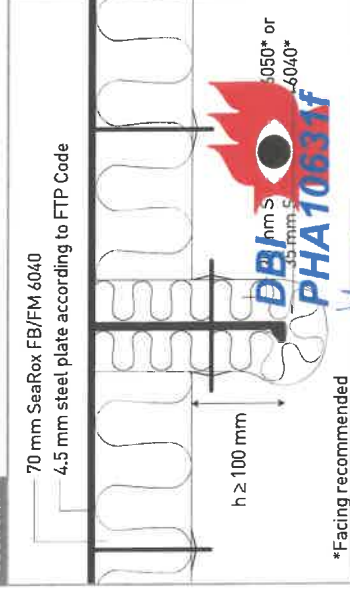

Handwritten signature



Subject: A-60 Steel Bulkhead
Plate: SeaRox FB/FM 6040
Stiffener: SeaRox FB/FM 6050 or SeaRox FB/FM 6040

TECHNICAL INSULATION

Date: 2021/10/25

Designer: DG

Drawing No. 700-3 / Rev 2

TOP VIEW

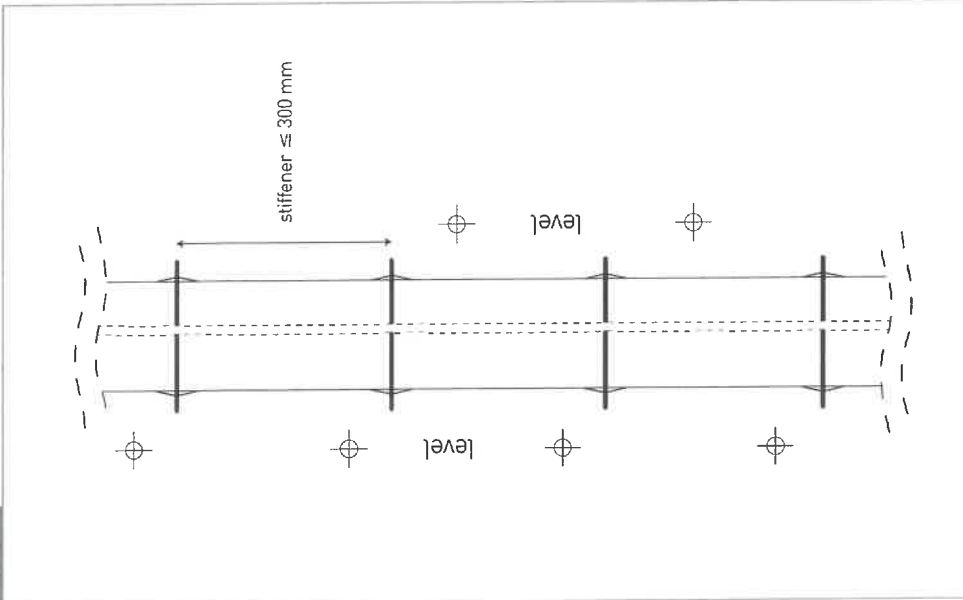

SECTION G

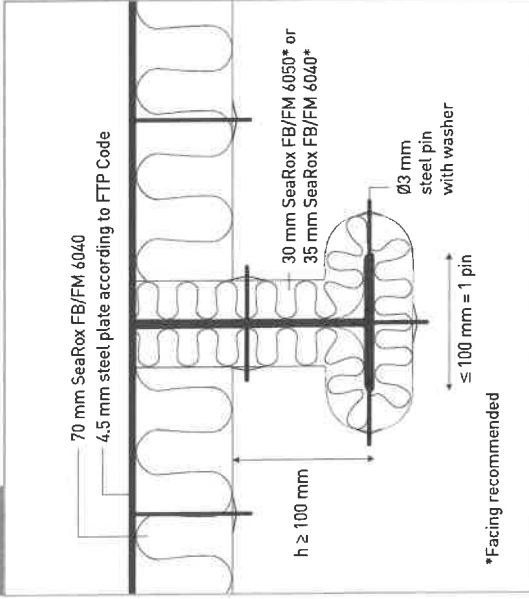

SECTION H

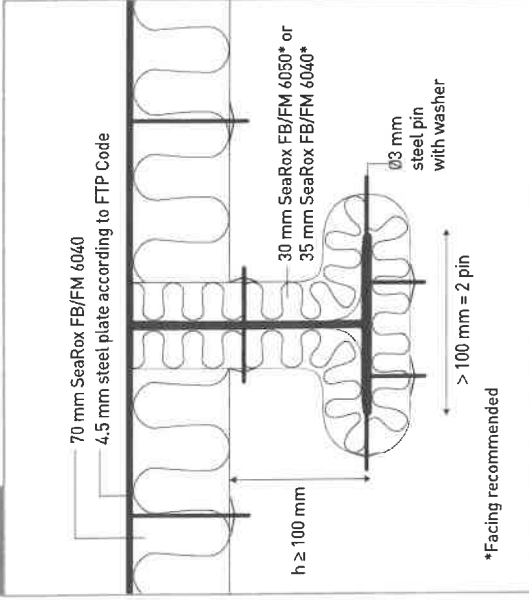

SECTION I

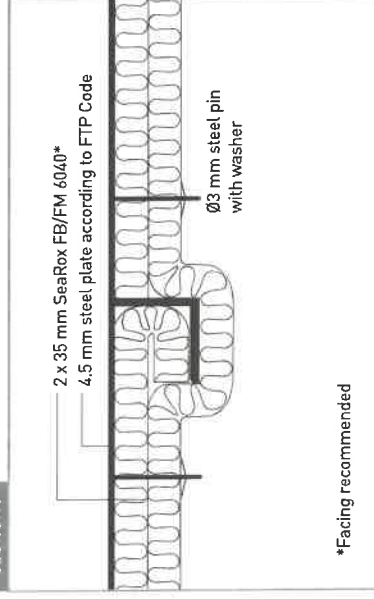

SECTION J

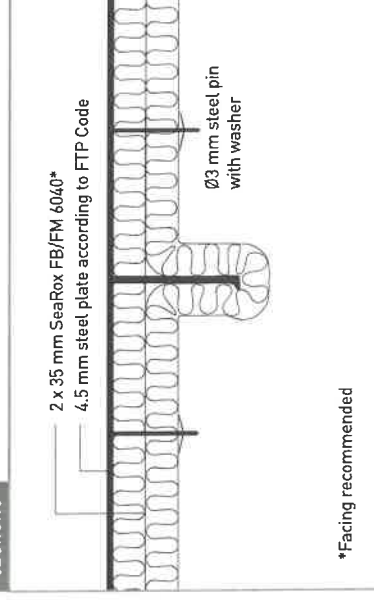

TECHNICAL INSULATION



Subject: A-60 Steel Bulkhead
Plate: SeaRox FB/FM 6040
Stiffener: SeaRox FB/FM 6050 or SeaRox FB/FM 6040

Date: 2021/10/25

Designer: DG

Drawing No. 700-4 / Rev 2