

STANDARD

MED B-00002B7

A-60 Aluminium Deck

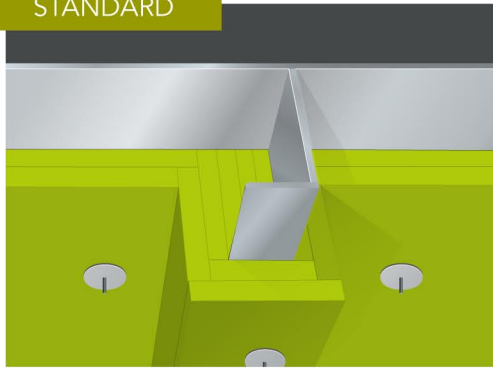

	Product	Thickness	Density	Weight
Plate	SeaRox SL 620	2 x 30 mm	100 kg/m ³	6.0 kg/m ²
Stiffener	SeaRox SL 620	2 x 30 mm	100 kg/m ³	6.0 kg/m ²

Construction notes:

- Stiffeners insulated with two layers of 30 mm SeaRox SL 620.
- Plate between stiffeners insulated with two layers of 30 mm SeaRox SL 620.
- Stiffeners 9 mm alu.
- Ø 3 mm aluminium-tipped stainless steel pins fixed with approx. 300/400 mm distance.
- Insulation secured with stainless steel washers of Ø 38 mm.

Application notes:

- All the connections must be tight.
- Gap under the stiffener must be filled out completely.
- Joints must be staggered, 150 mm overlap is recommended.
- The pins should exceed the insulation by approx. 10 mm.

Optional surface (on request):

- Reinforced aluminium foil
- Glass cloth

Advantages:

- 🎵 Secures excellent noise reduction and better comfort
- 👉 Lowest water absorption - optimal insulation performance

Sound reduction:

f	R
Frequency	1/3 Octave
Hz	dB
50	12.4
63	16.3
80	19.6
100	18.5
125	19.9
160	21.5
200	23.0
250	30.0
315	32.7
400	36.2
500	40.4
630	43.8
800	47.6
1000	50.9
1250	53.8
1600	55.6
2000	55.2
2500	55.3
3150	55.5
4000	58.4
5000	59.6

Sound Insulation, R (dB)

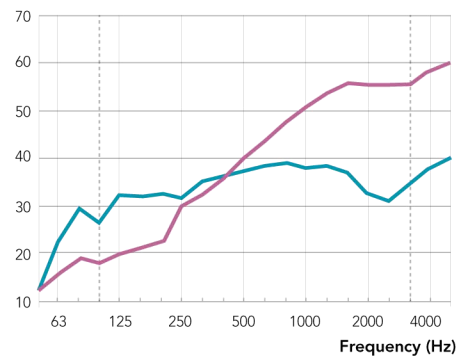

■ Test set-up: Plate: SeaRox SL 620, 2 x 30 mm
Stiffener: SeaRox SL 620, 2 x 30 mm

■ Steel Bulkhead 1500 / 1880 / 6 mm
Bulb profiles, 1820 / 140 / 10 mm
(without insulation)

$$R_w(C;C_{tr}) = 40 (-2; -7) \text{ dB}$$

Sound absorption:

Weighted sound absorption: **SeaRox SL 620, 60 mm**; $\alpha_w = 0.90$

Construction details

