

NON STANDARD

MED B-00002B4

## A-60 Steel Bulkhead

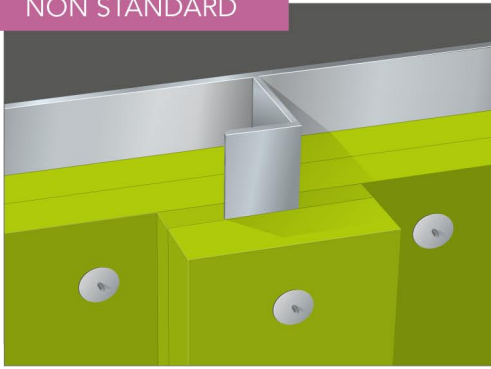

	Product	Thickness	Density	Weight
<b>Plate</b>	SeaRox SL 640	2 x 30 mm	130 kg/m <sup>3</sup>	7.8 kg/m <sup>2</sup>
<b>Stiffener</b>	SeaRox SL 640	30 mm	130 kg/m <sup>3</sup>	3.9 kg/m <sup>2</sup>

### Construction notes:

- Plate between stiffeners insulated with two layers of 30 mm SeaRox SL 640.
- Stiffeners insulated with 30 mm SeaRox SL 640.
- Ø 3 mm pins fixed with approx. 300 mm distance.
- Insulation secured with washers of Ø 38 mm.

### Application notes:

- All connections must be tight.
- Gap under the stiffener must be filled out completely.
- The pins should exceed the insulation by approx. 10 mm.
- Insulation must be placed on fire-exposed side of the steel plate.

### Optional surface (on request):

- Reinforced aluminium foil
- Glass cloth

### Advantages:

- 🎵 Secures excellent noise reduction and better comfort
- 🛡️ Lowest water absorption - optimal insulation performance

### Sound reduction:

f	R
Frequency	1/3 Octave
Hz	dB
100	29.9
125	28.8
160	31.7
200	34.2
250	35.8
315	39.2
400	43.2
500	46.3
630	49.5
800	54.3
1000	57.4
1250	60.1
1600	60.3
2000	60.4
2500	58.9
3150	61.0

Sound Insulation, R (dB)

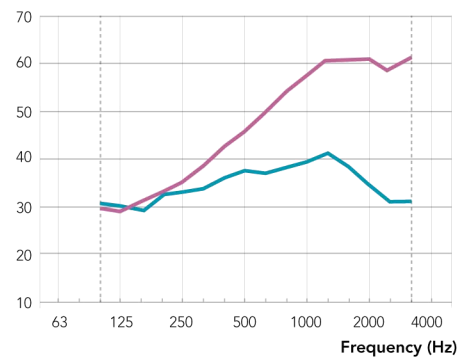

■ Test set-up: Plate: SeaRox SL 640, 2 x 30 mm  
Stiffener: SeaRox SL 640, 30 mm

■ Steel Bulkhead 1500/ 1500/ 5 mm  
L-profile: 60/ 30/ 5 mm  
(without insulation)

$$R_w(C;C_{tr}) = 48 (-1; -2) \text{ dB}$$

### Sound absorption:

Weighted sound absorption: **SeaRox SL 640, 2x30 mm**,  $\alpha_w = 0.90$

### Construction details

