

## NON STANDARD

MED B-00002B4

## A-60 Steel Bulkhead

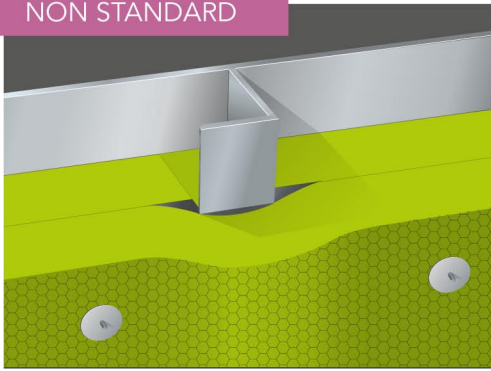

	Product	Thickness	Density	Weight
<b>Plate</b>	SeaRox WM 620	2 x 45 mm	90 kg/m <sup>3</sup>	8.1 kg/m <sup>2</sup>
<b>Stiffener</b>	SeaRox WM 620	45 mm	90 kg/m <sup>3</sup>	4.1 kg/m <sup>2</sup>

## Construction notes:

- Plate between stiffeners insulated with one layer of 45 mm SeaRox WM 620.
- Stiffeners and plate insulated in the same process with 45 mm SeaRox WM 620.
- Ø 3 mm pins fixed with max. 300 mm distance.
- Insulation secured with Ø 30-38 mm spring washers.

## Application notes:

- All connections must be tight.
- The pins should exceed the insulation by approx. 10 mm.
- Insulation can be placed on either side of the steel plate.
- Wire mesh must be twisted together at joints.

## Optional surface (on request):

- Reinforced aluminium foil

## Advantages:

- 🎵 Secures excellent noise reduction and better comfort
- 🔧 Lowest water absorption - optimal insulation performance

## Sound reduction:

f	R
Frequency	1/3 Octave
Hz	dB
50	12.7
63	12.7
80	18.6
100	23.6
125	25.1
160	30.3
200	32.9
250	39.9
315	43.2
400	46.9
500	49.6
630	51.5
800	53.3
1000	56.0
1250	59.1
1600	60.7
2000	61.9
2500	61.5
3150	59.5
4000	61.7
5000	61.2

## Sound Insulation, R (dB)

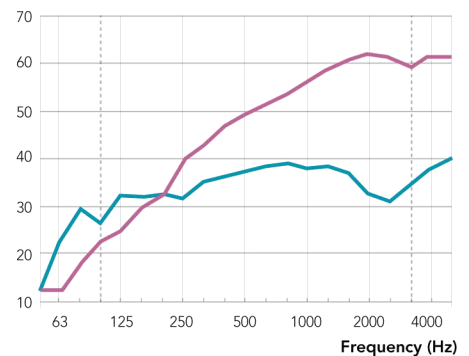

■ Test set-up: Plate: SeaRox WM 90, 2 x 45 mm  
Stiffener: SeaRox WM 90, 45 mm

■ Steel Bulkhead 1500 / 1880 / 6 mm  
Bulb profiles, 1820 / 140 / 7 mm  
(without insulation)

$$R_w(C;C_{tr}) = 49 (-3; -9) \text{ dB}$$

## Sound absorption:

Weighted sound absorption: SeaRox WM 620, 2 x 45 mm,  $\alpha_w = 0.95$

## Construction details

