

NON STANDARD

MED B-00002B4

A-60 Steel Bulkhead

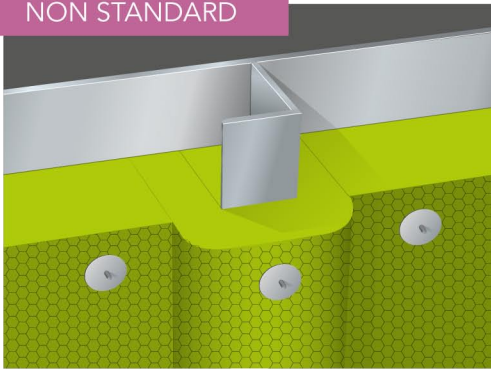

	Product	Thickness	Density	Weight
Plate	SeaRox WM 640	75 mm	105 kg/m ³	7.9 kg/m ²
Stiffener	SeaRox WM 640	30 mm	105 kg/m ³	3.2 kg/m ²

Construction notes:

- Stiffeners insulated with 30 mm SeaRox WM 640.
- Plate between stiffeners insulated with one layer of 75 mm SeaRox WM 640.
- Ø 3 mm pins fixed with approx. 300 mm distance.
- Insulation secured with washers of Ø 38 mm.

Application notes:

- All connections must be tight.
- Gap under the stiffener must be filled out completely.
- The pins should exceed the insulation by approx. 10 mm.
- Wire mesh must be twisted together at joints.
- Insulation can be placed on either side of the steel plate.

Optional surface (on request):

- Reinforced aluminium foil

Advantages:

- 🎵 Secures excellent noise reduction and better comfort
- 🛡️ Lowest water absorption - optimal insulation performance

Sound reduction:

f	R
Frequency	1/3 Octave
Hz	dB
50	10.2
63	15.2
80	20.6
100	23.0
125	24.9
160	30.0
200	30.7
250	37.7
315	41.5
400	45.9
500	49.3
630	51.4
800	52.8
1000	55.2
1250	58.5
1600	58.6
2000	59.4
2500	59.4
3150	58.3
4000	60.5
5000	60.9

Sound Insulation, R (dB)

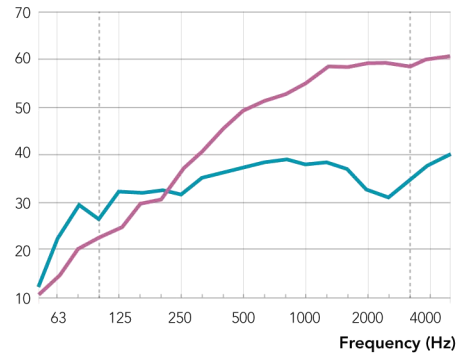

■ Test set-up: Plate: SeaRox WM 105, 75 mm
Stiffener: SeaRox WM 105, 30 mm

■ Steel Bulkhead 1500 / 1880 / 6 mm
Bulb profiles, 1820 / 140 / 7 mm
(without insulation)

$$R_w(C; C_{tr}) = 47 (-2; -8) \text{ dB}$$

Sound absorption:

Weighted sound absorption: **SeaRox WM 640, 75 mm**, $\alpha_w = 0.90$

Construction details

