

File no. G 10096

Tome Gillerup

Rockwool A/S

A-60 bulkhead
fire insulated with
2x30 mm Rockwool Marine Fire batts 130.

Drawing nr.:

1b

Date: 13.12.1995

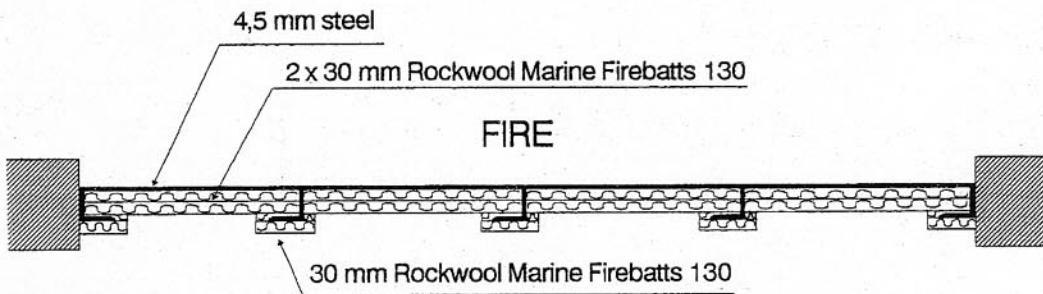

 Danish
 Institute of
 Fire Technology

File no. G 10096

Tommy Billestrup

Rockwool A/S

A-60 bulkhead
 fire insulated with
 2x30 mm Rockwool Marine Fire batts 130.

Drawing nr.:

2b

Date: 13.12.1995

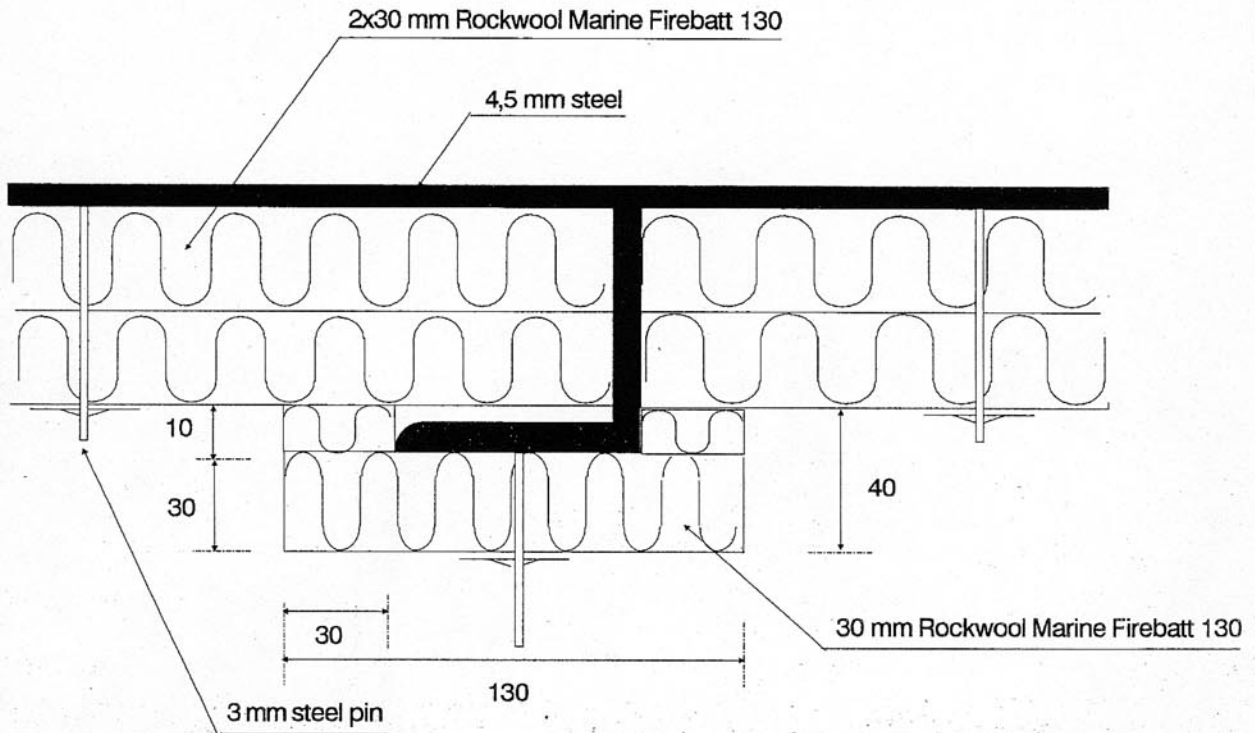

Danish
Institute of
Fire Technology

File no. G 10096

Tommy Billestrup

Rockwool A/S

A-60 bulkhead
fire insulated with
2x30 mm Rockwool Marine Fire batts 130.

Drawing nr.:

3b

Date: 13.12.1995